

M_x SYSTEM

furn_  io

3D printing of furniture to enrich your interior.

shelf

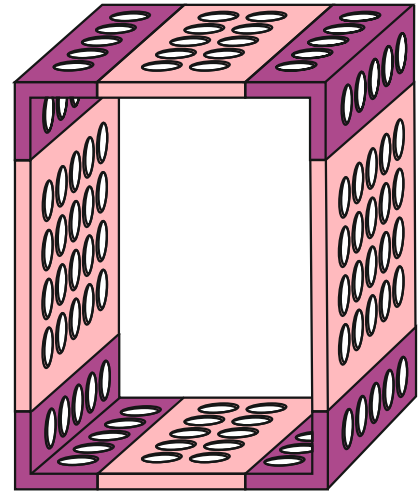
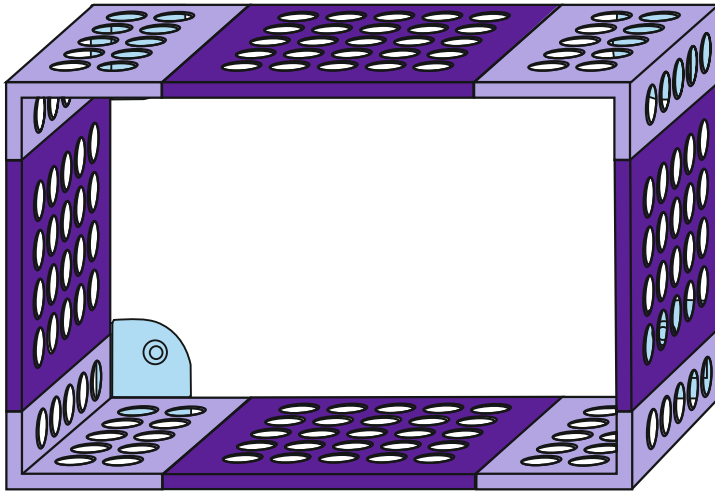

cabinet

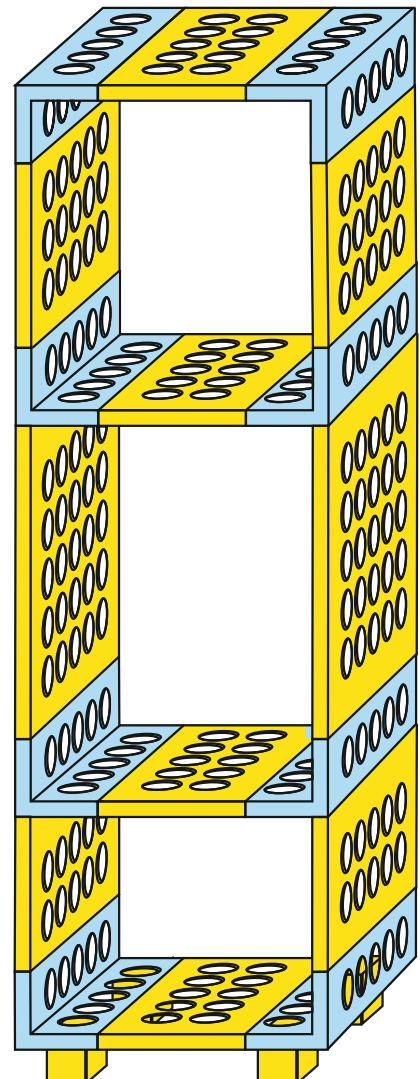
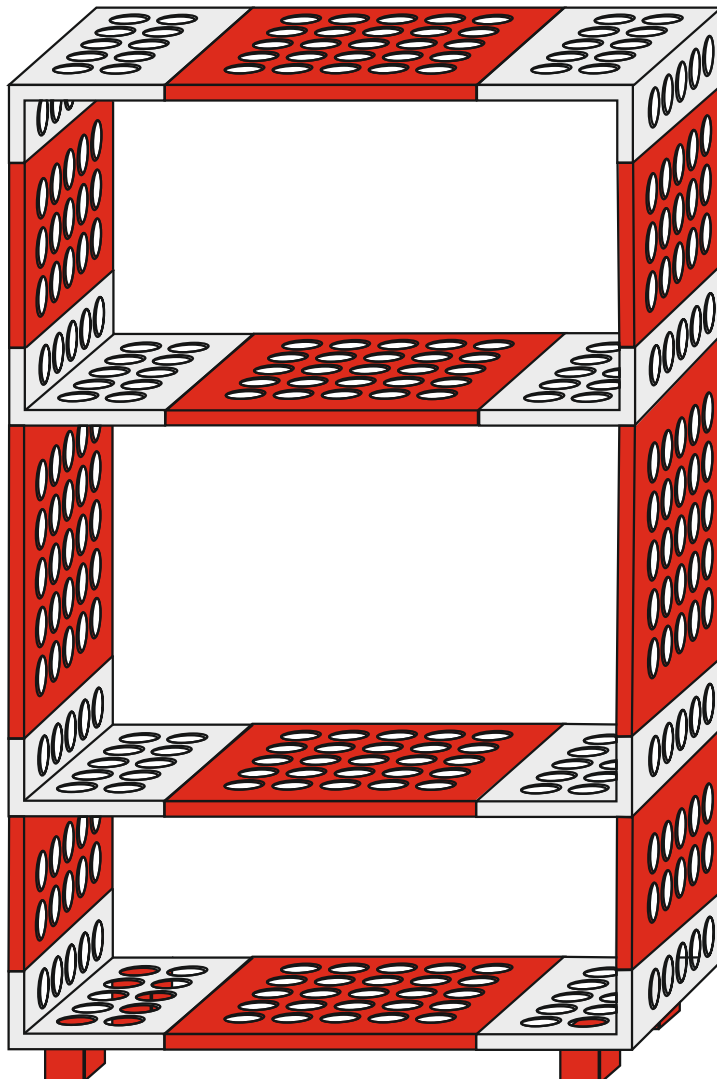



MX- SYSTÉM is a general storage and stacking system. Thanks to its variability, it will fit even more bulky things, but you can of course use it also to store things smaller-like CDs, toners for printers or books.

MX- SYSTÉM can be used either as shelves or you can assemble whole racks. The shelves only need to complement the cornery-both to strengthen the whole shelf and at the same time to mount on the wall, we will replenish the shelves again with legs. The amount of stacking is limited only to the height of your offices, the colors of shelves and shelves only to your imagination and the availability of filaments.

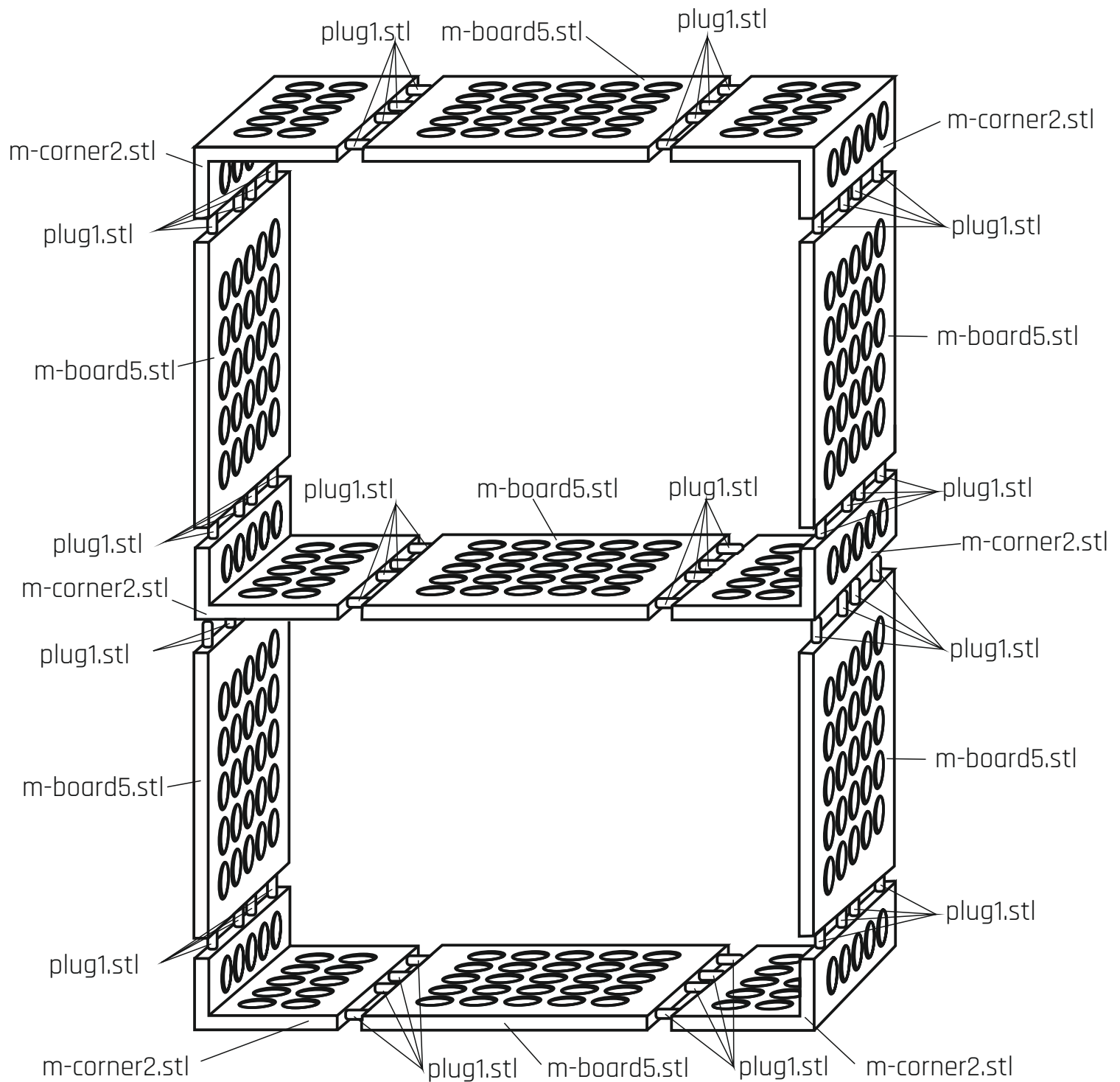

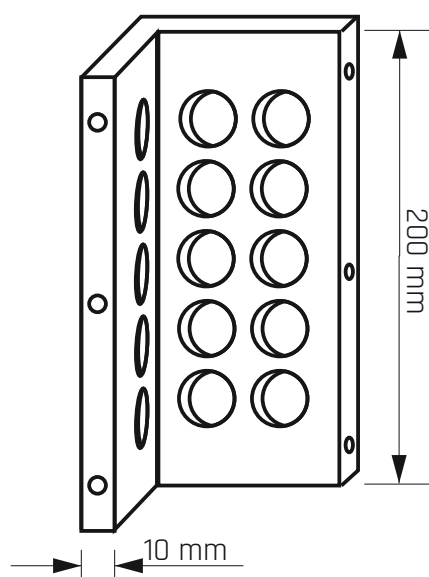

m-corner (variants 1-3)

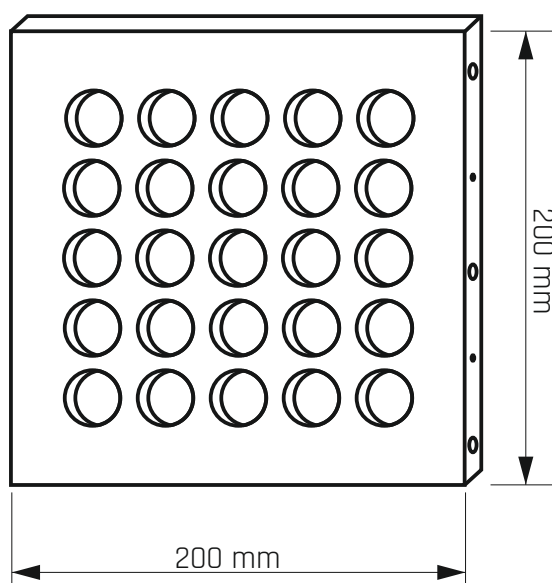

m-board (variants 1-6)

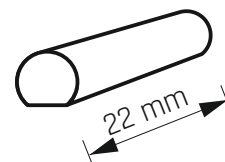

plug1
(diameter 8 mm)

MOŽNÁ POTŘEBA DÍLŮ

M1 - shelf

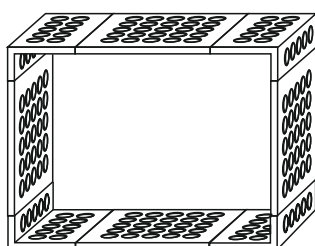

- 4 pc m-board
- 4 pc m-corner
- 32 pc plug1

M2 - shelf

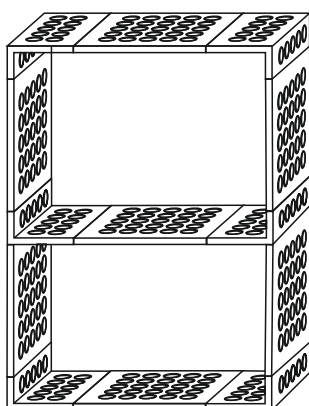

- 7 pc m-board
- 6 pc m-corner
- 56 pc plug1

Mx - bookshelf, cabinet

The parts can be combined at any height to create a system with different high shelves.

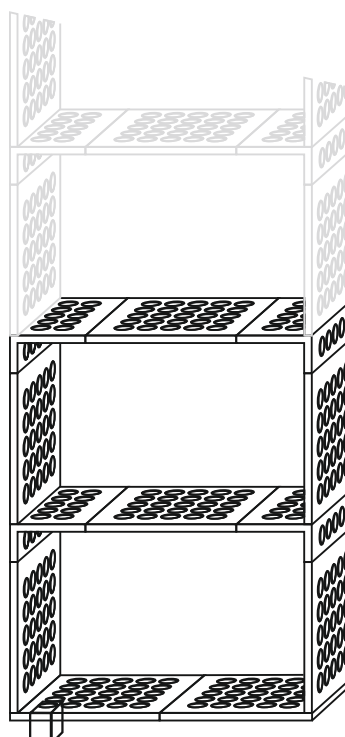

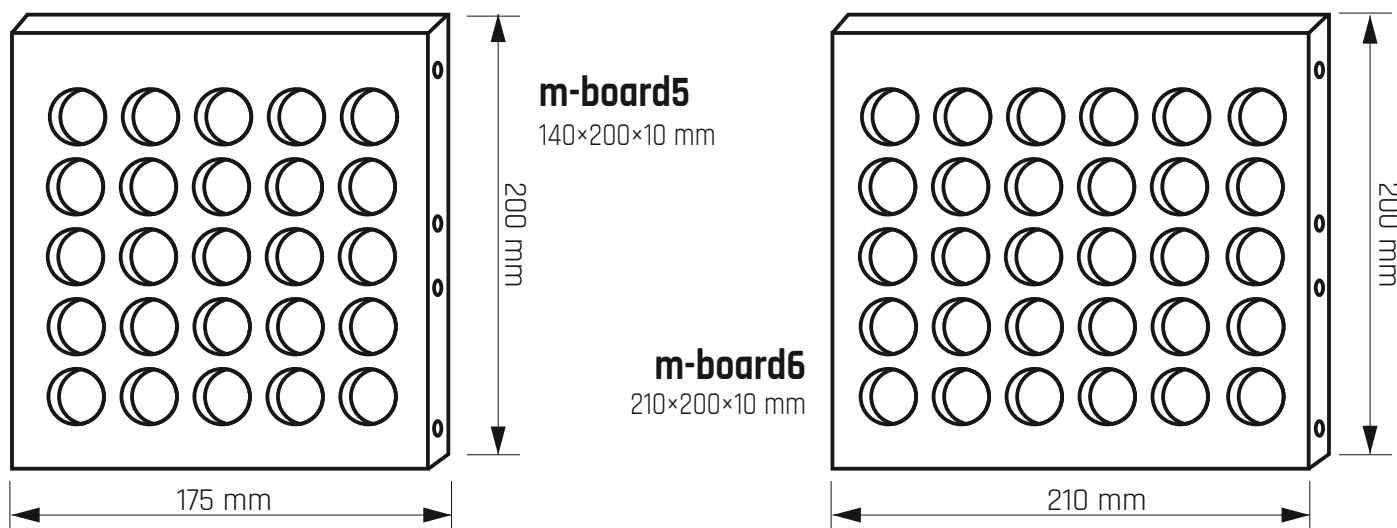
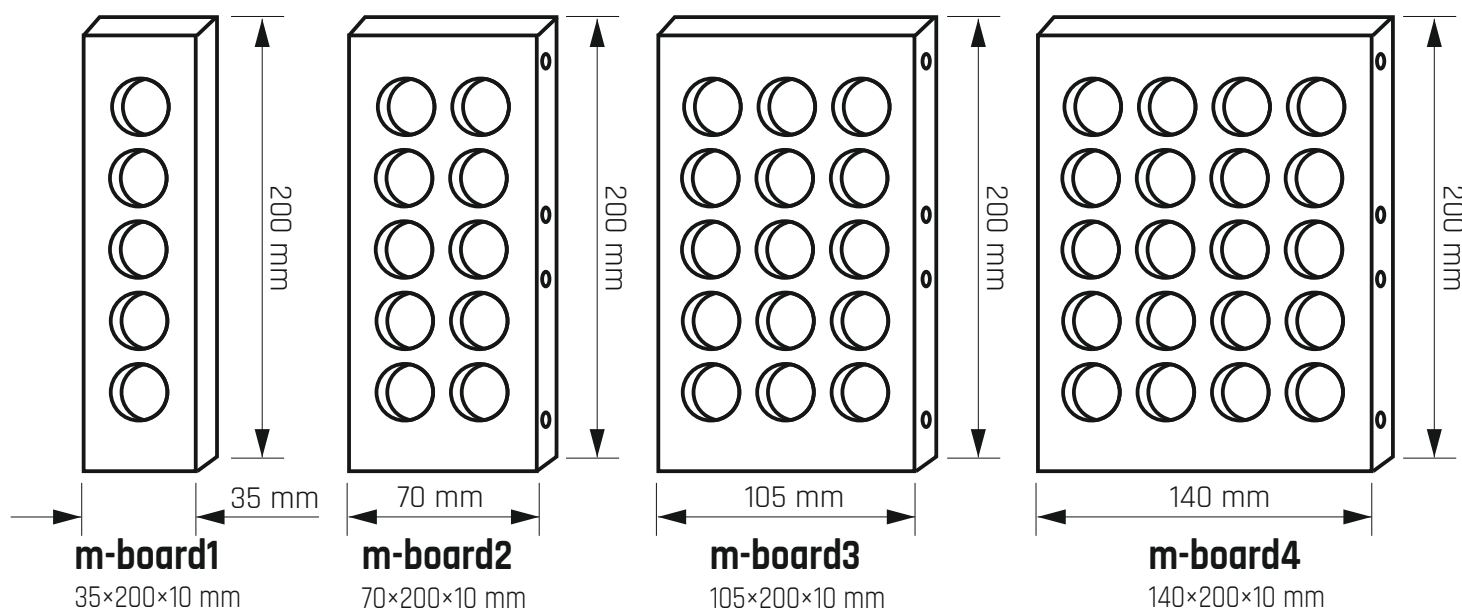
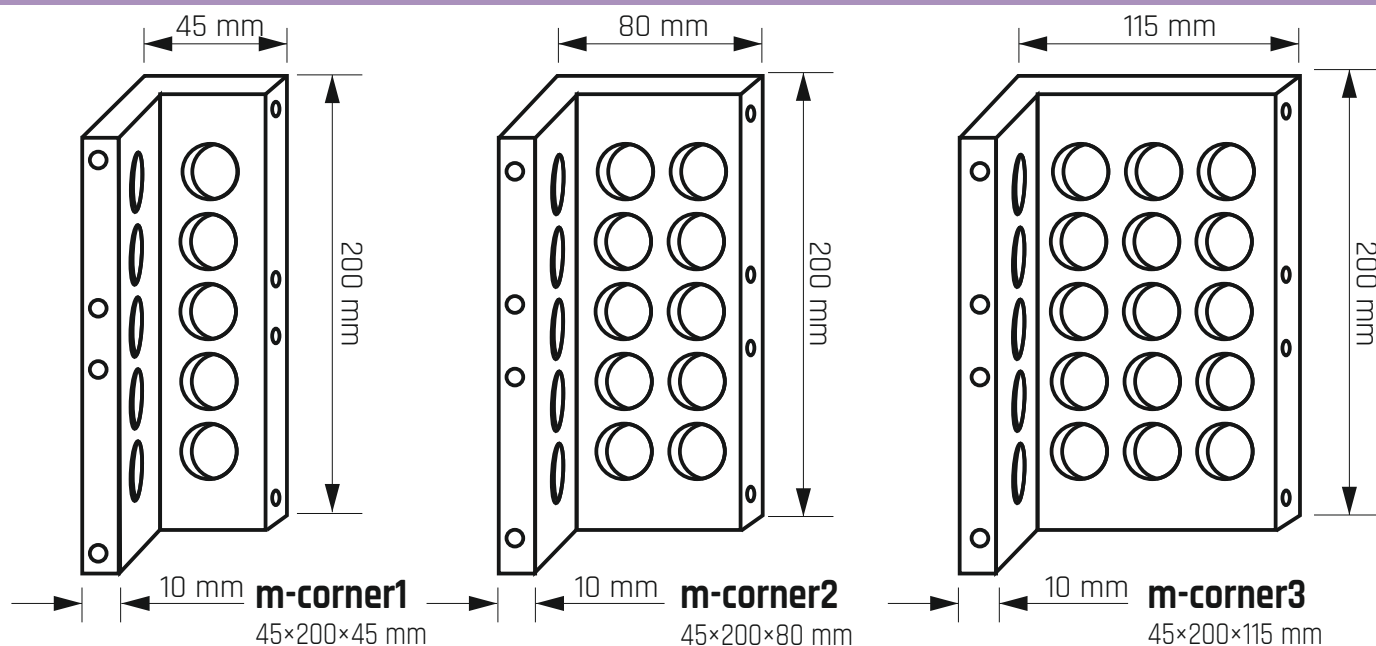

Cabinets leg - straight

leg_straight.stl

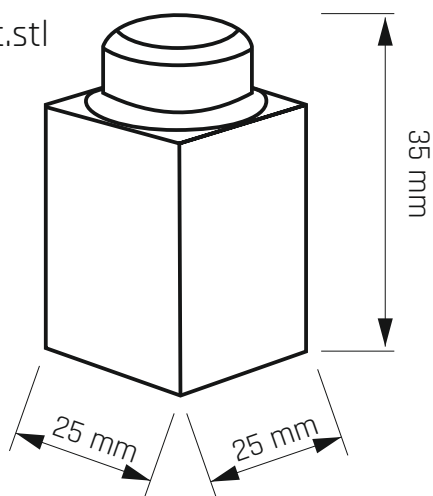

Cabinets leg - inclined

leg_inclined.stl

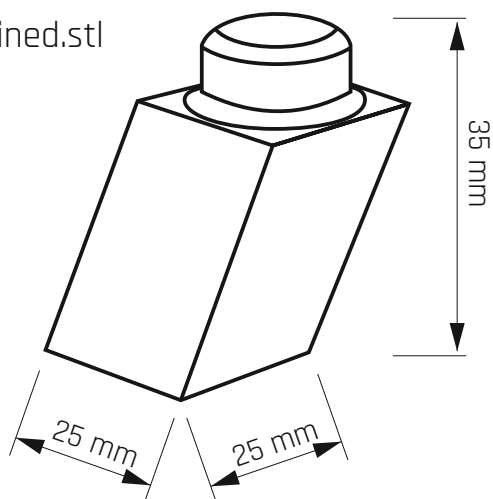

Corner for attaching the shelves to the wall

fasten_corner.stl

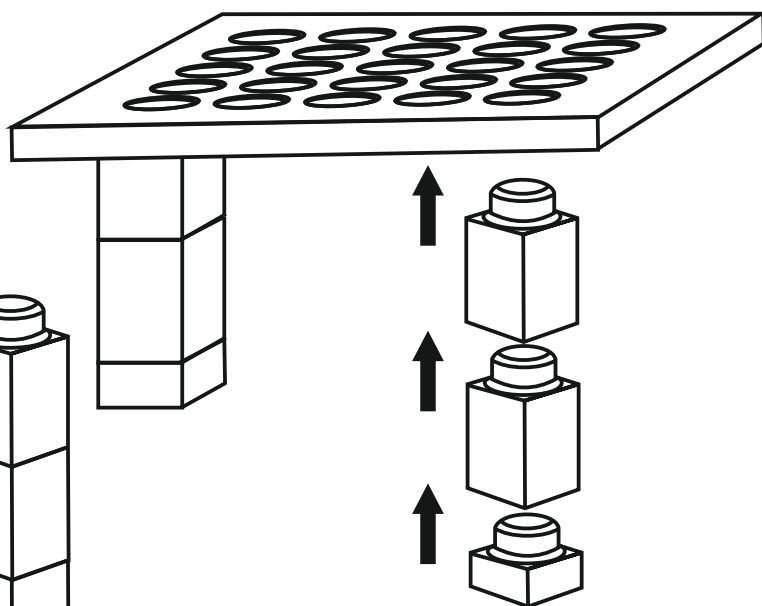
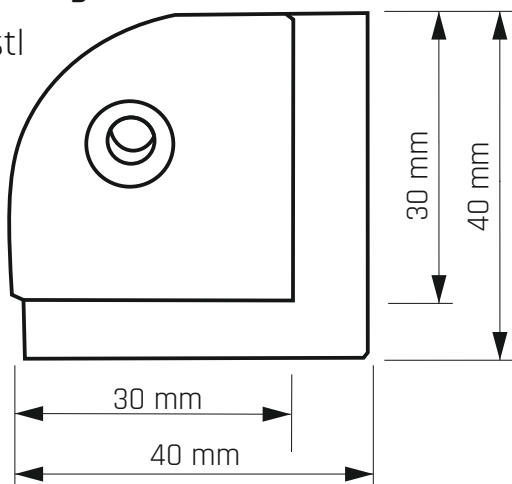

The resulting height of the foot can be chosen by folding and gluing more legs into each other. Finally, just add the blank. Attach the leg to the cabinet by gluing it into one of the holes m-board or m-corner. The imagination is not the limit, but for stability, the feet should be glued evenly.

Cabinets leg - blank

leg_blank.stl

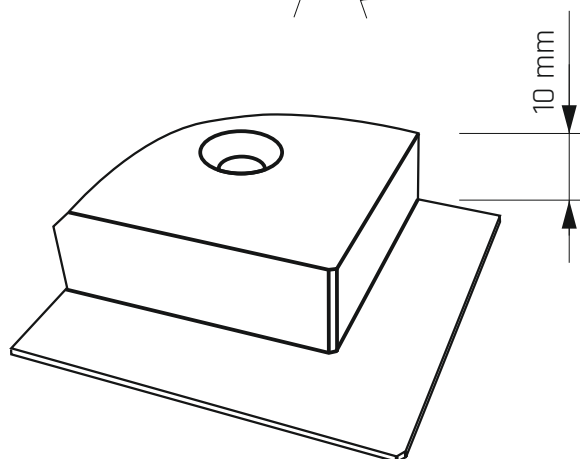
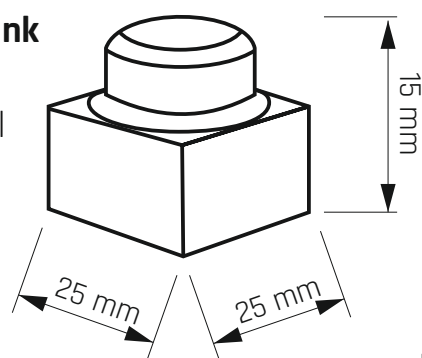

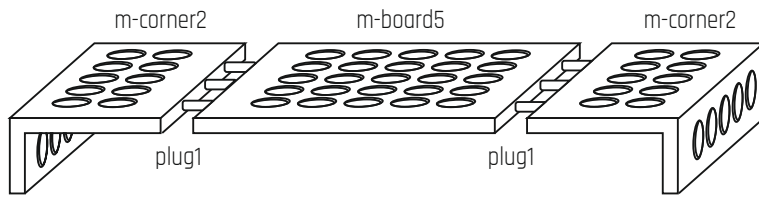

Step 1

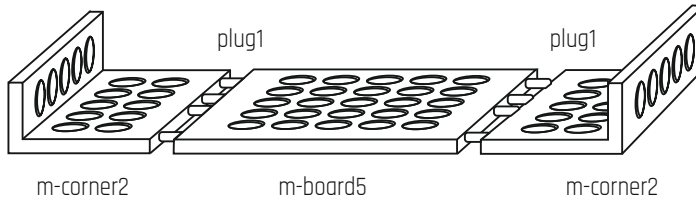

Step 2

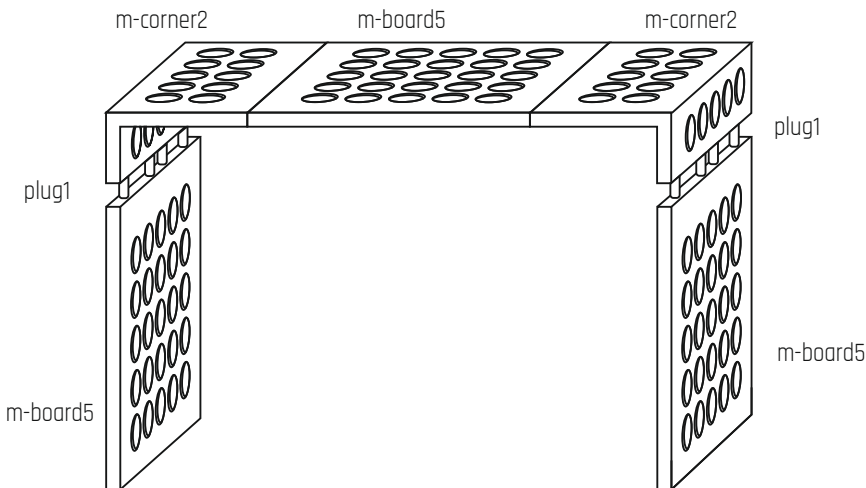

Step 3

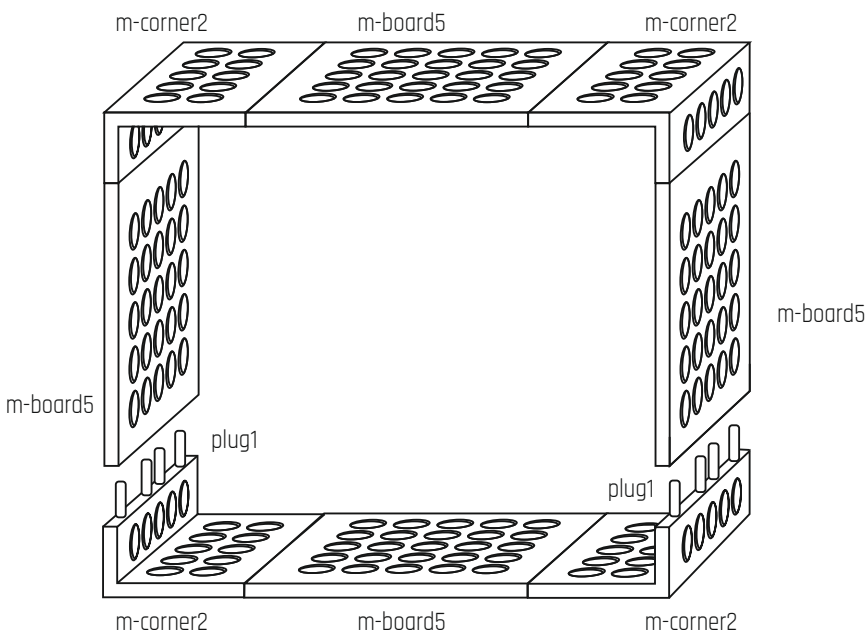

Step 4

Preparation

- Before you start gluing the shelves, always first try to attach the parts of the shelf to each other in the dry way without adhesive.
- If necessary, adjust the parts with a fine sandpaper or a small nail.
- Before connecting other parts, always allow the adhesive to dry thoroughly so that the joints are sufficiently strong. Follow the adhesive manufacturer's instructions.

Step 1 - top plate

- Put the glue into the holes of the m-board and insert the plug1. Press and wipe the adhesive residue with a cloth and leave to dry.
- Apply glue to the edges, press the m-corner to the m-board, wipe the adhesive residue and let it tighten

Step 2 - bottom plate

- Put the glue into the holes of the m-board and insert the plug1. Press and wipe the adhesive residue with a cloth and leave to dry.
- Apply glue to the suitable edge, press the M-board to each other, wipe the adhesive residue and let it tighten.

Step 3 - assembling the bottom part

- Glue plug1 into the holes of the bottom plate and let it tighten.
- Apply glue to the suitable edge of the side m-board, press it to the bottom plate, wipe the adhesive residue and let it tighten.

Step 4 - finishing shelves

- Glue plug1 into the holes of the lower part and let it tighten.
- Apply glue to the suitable edge of the top plate, tie the bottom part of the shelf, wipe off the adhesive residue and let it tighten.

Other variants can be built in analogous manner.

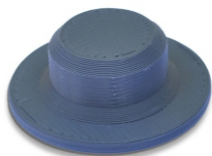
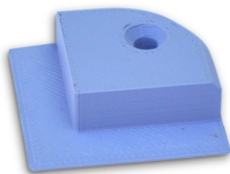
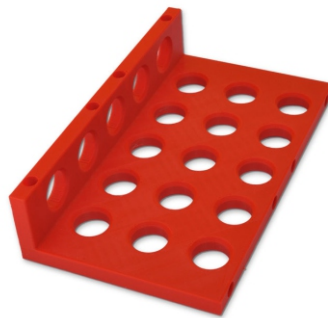
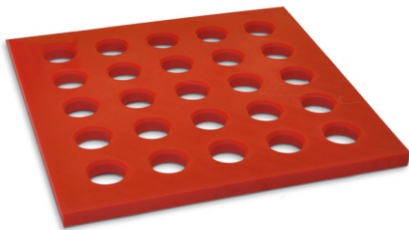
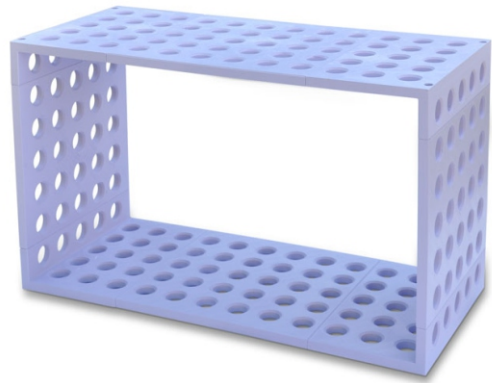
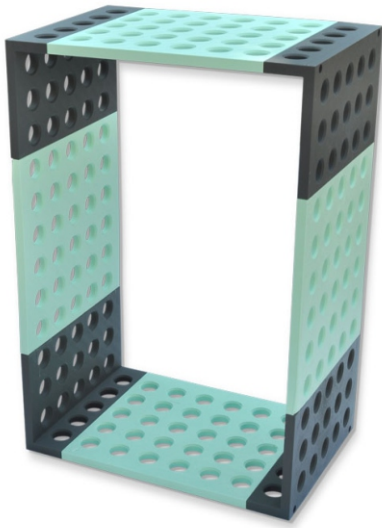



To glue the parts we recommend adhesive
UHU All Plastics.